



GOBUDS 400

True Wireless Earbuds

Get ready for MORE, for a LIFE of WOW with your all new GOBUDS 400. We strongly recommend you go through this manual entirely before beginning to use the product, as it contains important technical information to ensure a seamless audio experience. It can also be referred to in times of difficulty.

PACKAGE CONTENTS

- 1 x GOBUDS 400
- 1 x Type C Charging Cable
- 1 x Warranty Card
- 1x Charging case
- 1 x Manual
- 2x Additional Ear Muffs

CHARGING

- Earbuds are partially charged, Please ensure you fully charge them before you use them for the first time.
- Plug the Type C cable into the charging port of any USB charging adapter or active computer USB port.
- Charging will start automatically, and the LED indicator will turn white
- The earbuds are fully charged when the LED indicator turns white for 60s and then turns off.

Note: Charge the earphones at least once month when they are not in use for a long time.

PAIRING DEVICE

Pairing steps for mobile :

- After opening the cover of the charging case the earbuds are automatically turned on and paired with each other.
- Press the button at the back of the case. The device will automatically enter into pairing mode.
- Select from the list of the available bluetooth devices on your phone the GOBUDS 400, while keeping the earbuds close to mobile.
- The earbuds indicator will flash with orange and white light indicating a successful connection.
- GOBUDS 400 will automatically be connected to the paired device, just by removing the earbuds from the charging case.

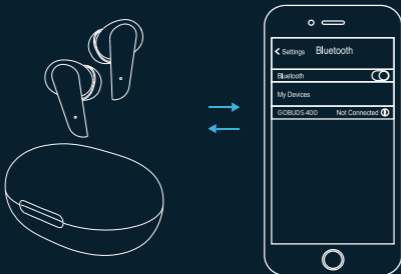

HOW TO USE

Power On	Touch and hold the MFB button 5 sec
Power Off	Touch and hold the MFB button 5 sec
Answer call	Touch the Left or Right MFB button once
End call	Touch the Left or Right MFB button once
Reject call	Touch the Left or Right MFB button 2 sec
Music play/pause	Touch the Left or Right MFB button once
Previous song	Touch and hold the left MFB for 2 sec
Next song	Touch and hold the right MFB for 2 sec
Voice assistant	Touch the L/R MFB 3 times to activate Voice assistant
Game Mode On/Off	Touch the L/R MFB 4 times to activate Game mode

Reset:

Take out the earbuds and Touch the Left and right MFB 5 times quickly.

Note: The volume cannot be controlled via the earbuds. You may control the volume via the phone or media device

SPECIFICATION

Model	GOBUDS 400
Driver size	10mm
Frequency Range	20Hz-20kHz
Sensitivity	114dB±3dB
ENC	Environment Noise Cancellation
Case Battery Capacity	300mAh
Earbuds Battery Capacity	3.7V/40mAh*2
Total Playtime	25 Hours
Earbud Playtime	7 Hours
Standby Time	160 Hours
Fast Charge	120 mins playtime with 10 mins charge
Full Charge	40 mins
Charging Port	Type C
Input Voltage	5VDC, 1A
Water Resistance	IPX4
Bluetooth	V5.3
Transmission Dist.	10m

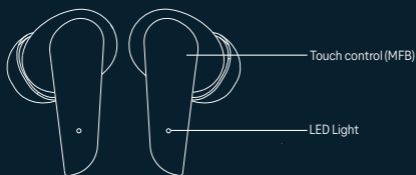

MONO MODE

GOBUDS 400 support MONO MODE. More specifically, the earbuds can be connected even by using only one of the two earbuds separately. More specifically:

1. Take one earbud out of the charging case. The earbud automatically turns on and reconnects to the previously connected device.
2. You can switch from one earbud to the other while playing music. You just need to take out the other earbud from the charging case and then both earbuds will be connected automatically. After that, you can move the initial earbud back to the case, which will auto disconnect. The switching process is now complete.

SAFETY INSTRUCTIONS

- 1 Please read, follow and keep these instructions. Heed all warnings on the product and in the instructions for use.
- 2 Stop using this product immediately if it causes discomfort or pain. When using this product, it is recommended that you limit the volume to help avoid causing harm to your ears and danger resulting from being unable to hear what is going on around you.
- 3 Keep the device out of extreme heat and humidity. Do not use the device near water, such as sinks, bathtubs, swimming pools, washing machines, tubs of water, etc.
- 4 Observe all signs and instructions that require an electrical device or radio product to be switched off in designated areas, such as petrol/refueling stations, hospitals, blasting areas, potentially explosive atmospheres, and aircraft.
- 5 Using earphones while driving can distract you and increase the likelihood of an accident. If driving conditions demand it (such as bad weather, high traffic density, presence of children in the car, difficult road conditions), pull off the road and park before making or answering calls.
- 6 Battery life may differ depending on personal habits.
- 7 Please do not rotate the headset when the head band has been set/pushed to the lowest position.
- 8 This appliance should be used in moderate climates.

WARNING

- To prevent potential hearing damage, do not listen to high volume levels for long periods.
- Do not turn the volume up too high; doctors warn against prolonged exposure to high volumes.
- Stop using the product or lower the volume if you feel your ears ringing. Prolonged listening at high volumes could lead to hearing damage.

Life's too short for "ok". Too short to have stuff in our lives that's "ok, I guess". "But-I'm-almost-home!" battery life. "But-it-only-fell-off-the-table" build quality. "Has-someone-stolen-the-bass?" sound quality.

We say NO to "ok". In 2021, we set out to make stuff that's better in little ways that make a big difference.

Stuff for people who expect more. Who want the songs to keep playing until they're home. Who are on a mission to stay up all night. Who want to know they'll feel great and look awesome, every day.

For people who want every day to be a "WoW" day.